

How to Establish MySQL Workbench remote connection

1. Find the command line:
 - a. Mac users: Locate the “Terminal” application by going to Applications > Utilities > Terminal
 - b. Linux users: Find the terminal in the list of applications (typing “terminal” in the search bar)
 - c. PC users: Search for “command prompt” in your applications
 - i. You must have Windows 10 or 11 to complete it this way on a PC
2. You should see a black (Linux or PC) or white (Mac) terminal window
3. Enter the following command:
 - a. `ssh -L 3306:canary.simmons.edu:3306 username@web.simmons.edu`
 - i. **example:**
`ssh -L 3306:canary.simmons.edu:3306 rolka@web.simmons.edu`

Note: The first time you connect to web.simmons.edu on a computer you haven't used before, you will get a warning that asks if you are sure you want to add web.simmons.edu to your list of trusted sites. Type “yes” and press Enter

Note: You will be prompted for your password; when you start typing, no characters will appear in the window. Just type your password as you normally would and press Enter when you are done

*Note: if you have an error message because you are already connected to 3306 port somewhere else, change the **first** 3306 to 3307*

example: `ssh -L 3307:canary.simmons.edu:3306 rolka@web.simmons.edu`

4. Here is where you will specify which two-factor authentication method you would like to use. After entering your password, you should get a prompt like this

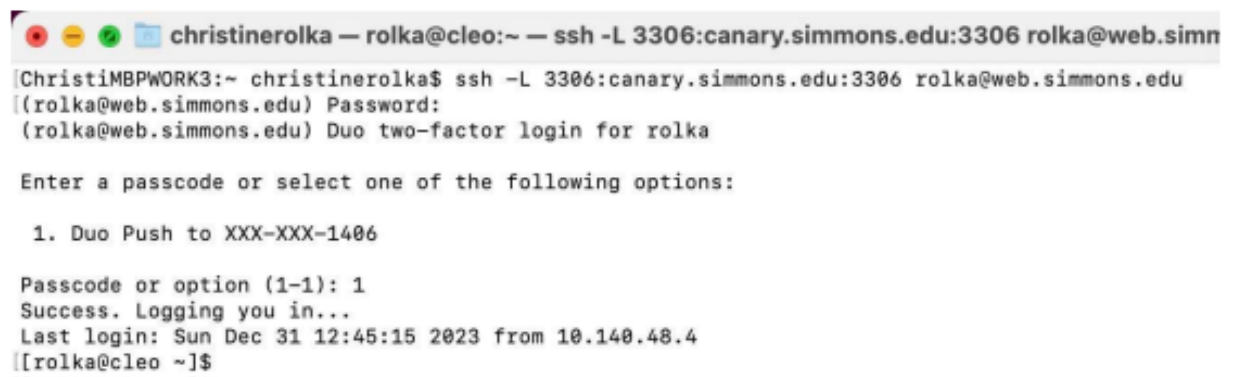

```
christinerolka — rolka@cleo:~ — ssh -L 3306:canary.simmons.edu:3306 rolka@web.simn
[ChristiMBPWORK3:~ christinerolka$ ssh -L 3306:canary.simmons.edu:3306 rolka@web.simmons.edu
(rolka@web.simmons.edu) Password:
(rolka@web.simmons.edu) Duo two-factor login for rolka

Enter a passcode or select one of the following options:

1. Duo Push to XXX-XXX-1406

Passcode or option (1-1): 1
Success. Logging you in...
Last login: Sun Dec 31 12:45:15 2023 from 10.140.48.4
[rolka@cleo ~]$
```

5. Type "1" to select the Duo option. Press Enter.
6. Complete the Duo Prompt on your phone. You may need to open the Duo app.
7. Keep the terminal window **open**, and open MySQL Workbench (double check that you are running MySQL Workbench version 8.0.28 or later).

*Note: always leave the terminal window **open** when working in MySQL Workbench*

8. Create a new connection by selecting the "+" sign
9. In the "Setup New Connection", use the following values:
 - a. **Connection Name:** *you can name this whatever you would like (ex. Simmons Remote Connection)*
 - b. **Connection Method:** Standard (TCP/IP)
 - c. **Hostname:** 127.0.0.1
 - d. **Port:** 3306
 - e. **Username:** *your Simons username (ex. rolka)*
 - f. **Password:** *your Student ID number*

Note: you can enter your password after clicking the "Store in keychain" (Mac) or "Store in vault" (PC) button

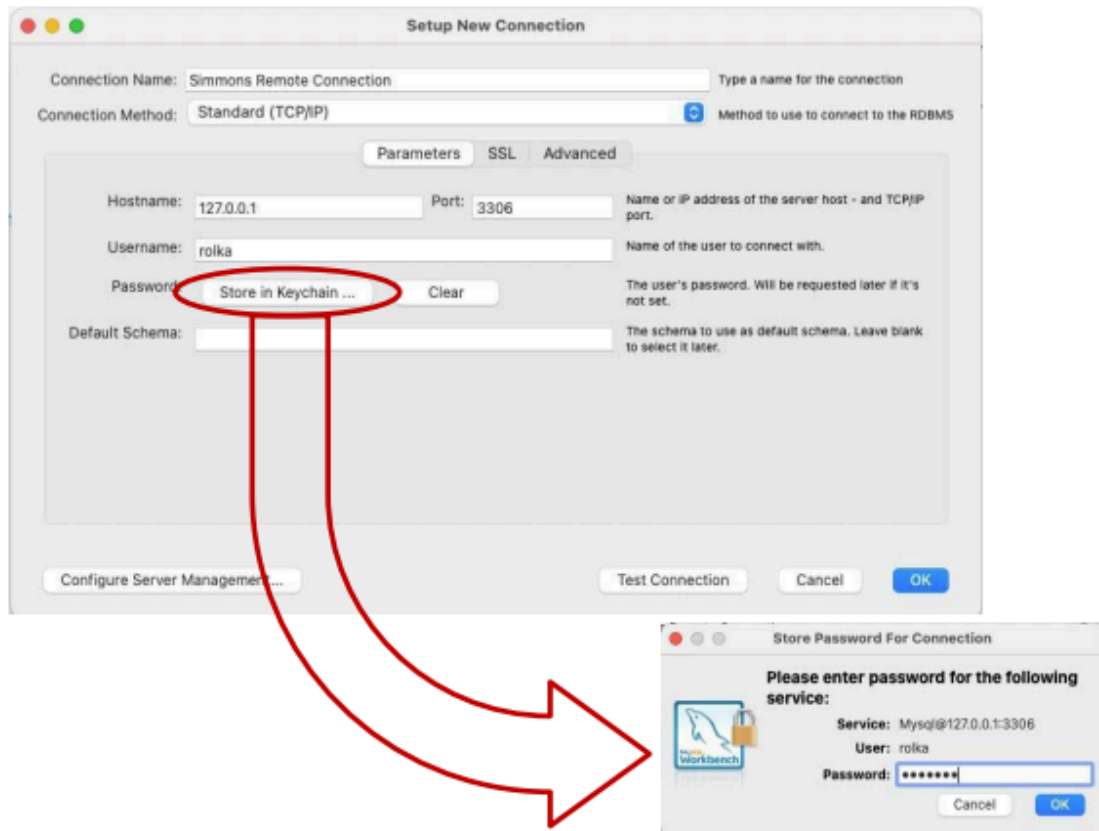

Fig. 1: completed Network Connection

10. Press "Test Connection"

a. A connection warning will pop up. Click "Continue anyway"

11. If it is successful, press OK and you can open it!